

INT FM5 series

Face & Palm Verification and
Fever Detection

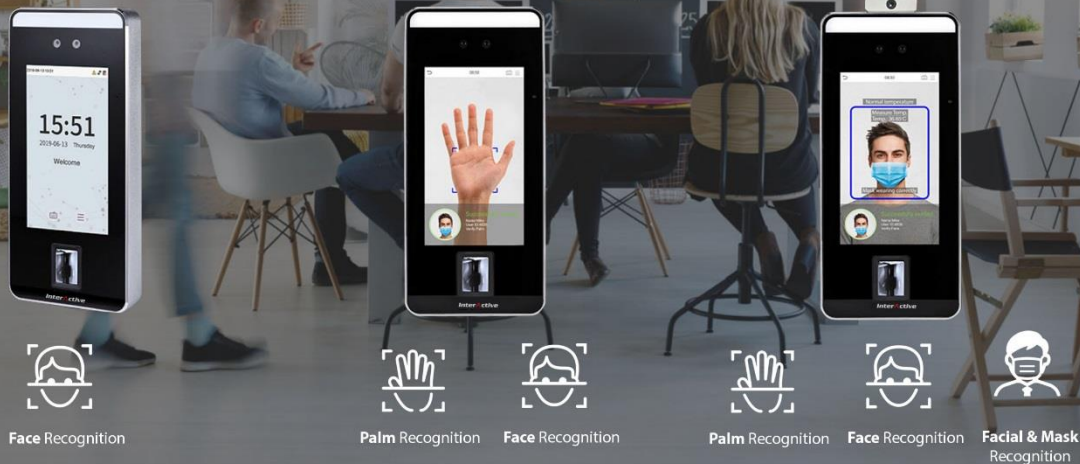

INT FM5 is using intelligent engineering facial recognition algorithms and the latest computer vision technology. It supports both facial and palm verification with large capacity and speedy recognition, as well as improves security performance in all aspects.

INT FM5 adopts touchless recognition technology and new function namely fever detection and masked individual identification which eliminates hygiene concern effectively. It is also equipped with ultimate anti spoofing algorithm (Palm Shape, Palm Print and Palm Vein) is performed in 0.35 sec per hand, the palm data acquired will be compared with a maximum of 3000 palm templates.

Features

- Visible Light Facial Recognition
- Better hygiene with touchless biometric authentication, fever detection and masked individual identification
- Anti spoofing algorithm against print attack (laser, color and B/W photos), videos attack and 3D mask attack
- Multiple Verification methods : Face / Palm / Fingerprint / Card / Password

Anti Epidemic Function

- Mask Detection
- Body temperature detection
- Temperature Measurement Distance : 30-50cm (1-1.64ft)
- Temperature Measurement Accuracy : 0.3°C
- Temperature Measurement Range : 34 - 45°C

Specifications

Display	5 inch Touch Screen
Face Capacity	6000
Palm Capacity	3000
Fingerprint Capacity	6000 (standard) 10.000 (optional)
Card Capacity	10.000
Transactions	200.000
Operating System	Linux
Standard Functions	ID Card, ADMS, T9 Input, DST, Camera, 9 Digit user ID, Access Levels, Groups, Holidays, Anti passback, Record Query, Tamper Switch Alarm, Multiple Verify Mode
Hardware	900MHz Dual Core, CPU Memory 512 MB RAM / 8G Flach, 2MP WDR Low Light Camera, Adjustable Light Brightness LED
Communication	TCP / IP, Wifi (optional) Wiegand input / output, RS485
Access Control Interface	3rd Party Electric Lock, Door Sensor, Exit Button, Alarm Output, Auxiliary Input
Optional Function	13.56 MHz IC Card (MF)
Facial Recognition Speed	<=1S
Power Supply	12V 3A
Operating Humidity	10%-90%
Operating Temperature	-10°C - 45°C
Dimensions (W*H*D)	91.93 *202.93 *21.5mm

Configuration

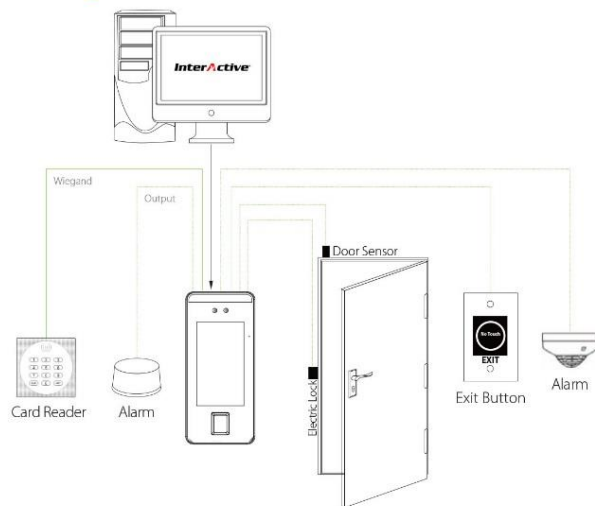

Dimensions (mm)

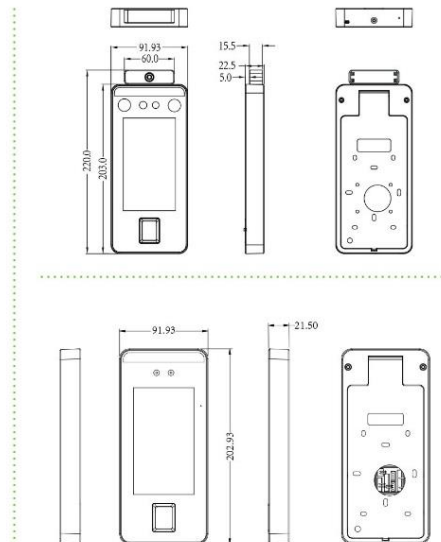

InterActive®